

Ecco Low Pressure Spray Guns for professionals

Developed for the professional user

The Ecco equipment for conventional air spraying has been developed by skilled engineers in close co-operation with the paint manufacturers and the industrial user for more than 60 years.

For the highest finishing demands

Ecco's conventional air spray guns are used in many industrial sectors where top quality finish, high capacity and durability are essential.

Total versatility

Thanks to a wide range of air caps and paint nozzles almost all material can be applied to the highest quality, fast.

For every application

Ecco also offers *ready-to-use* units and accessories for all kind of applications.

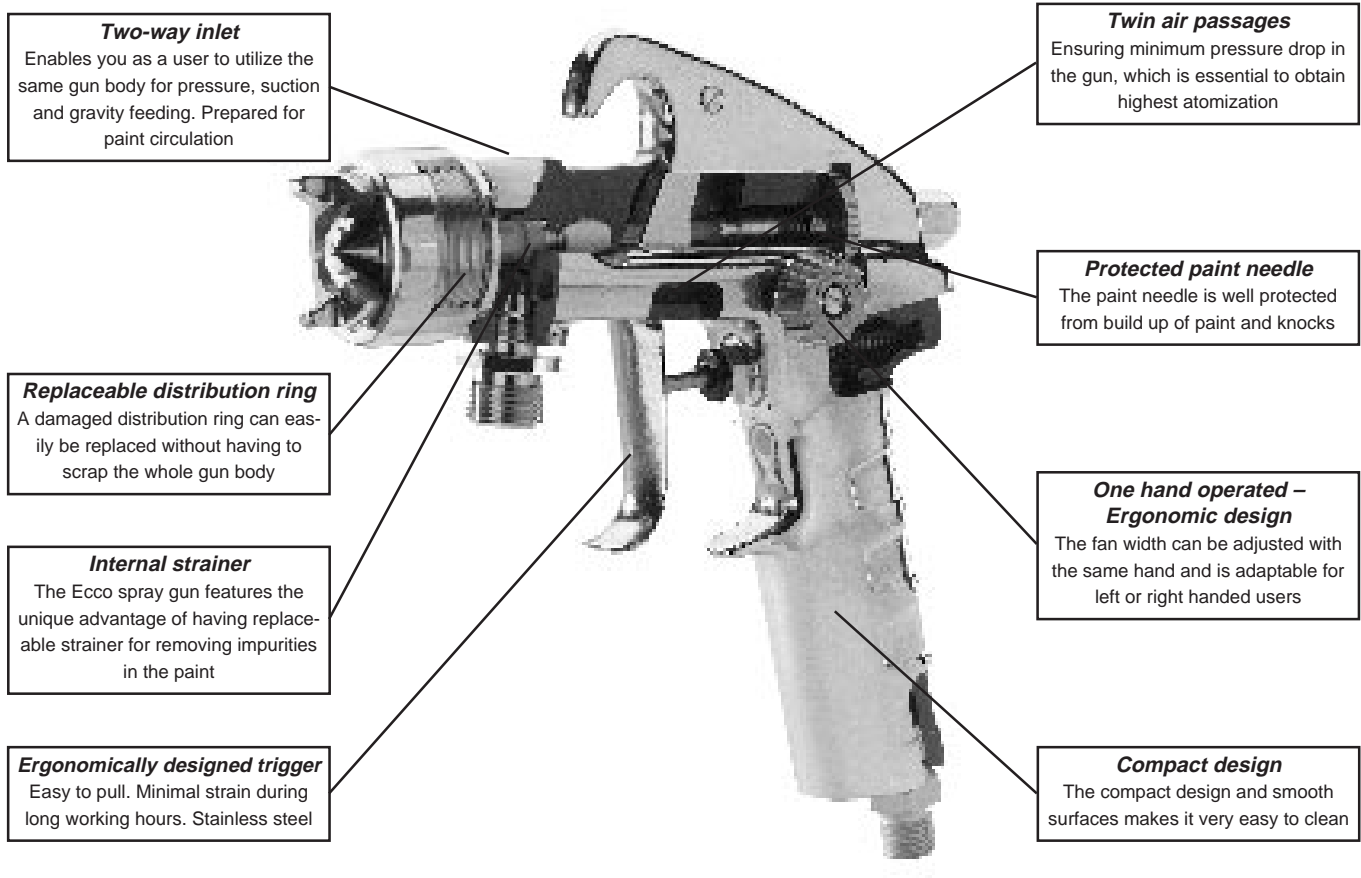

Two-way inlet

Enables you as a user to utilize the same gun body for pressure, suction and gravity feeding. Prepared for paint circulation

Twin air passages

Ensuring minimum pressure drop in the gun, which is essential to obtain highest atomization

Replaceable distribution ring

A damaged distribution ring can easily be replaced without having to scrap the whole gun body

Protected paint needle

The paint needle is well protected from build up of paint and knocks

Internal strainer

The Ecco spray gun features the unique advantage of having replaceable strainer for removing impurities in the paint

One hand operated - Ergonomic design

The fan width can be adjusted with the same hand and is adaptable for left or right handed users

Ergonomically designed trigger

Easy to pull. Minimal strain during long working hours. Stainless steel

Compact design

The compact design and smooth surfaces makes it very easy to clean

A nozzle combination for every application

High or low viscosity, aggressive or abrasive fluids – there is an Ecco spray gun for every need.

Ecco offers a wide range of air caps, paint nozzles and paint needles.

Please see page 15 or contact your nearest Ecco distributor for further information.

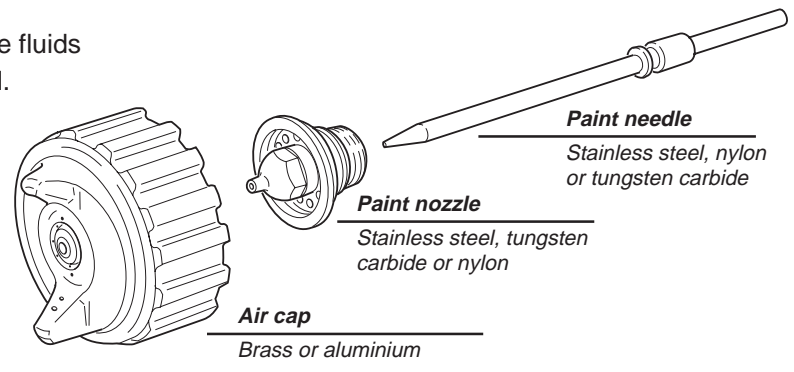

Air cap

Brass or aluminium

Paint nozzle

Stainless steel, tungsten carbide or nylon

Paint needle

Stainless steel, nylon or tungsten carbide

Ecco 40 – a first class spray gun

The manual Ecco 40 spray guns are easily operated, durable and well balanced. Precision machined paint and air channels together with top quality design, ensures a high capacity, excellent atomization and finishing result. The guns are service friendly and do not require any special tooling.

As standard the spray guns are equipped with stainless steel paint nozzle and nylon paint needle. The spray guns are also available with stainless steel fluid channels.

When you choose an Ecco product you are choosing a quality product with proven reliability second to none.

Ecco 40 / 40 S – Pressure feed



Fluid supplied from pressure pots, pumps or circulation systems.

Technical data	
Paint nozzles:	0.8 - 6.5 mm
Paint connection:	G 3/8
Air connection:	G 1/4
Air pressure:	max. 7 bar
Air consumption:	250 - 700 l/min
Weight:	640 g

Selection of gun (paint nozzle size)

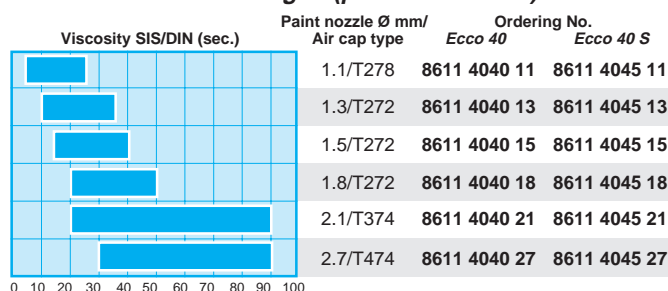

See also chart at page 14.

Ecco 40 / 40 S / 401 – Suction feed



Ecco 40 and Ecco 40 S (stainless steel) without suction cup. Ecco 401 consists of an Ecco 40 and a 1.0 lit. suction cup.

Technical data	
Paint nozzles:	0.8 - 2.7 mm
Paint connection:	G 3/8
Air connection:	G 1/4
Air pressure:	max. 7 bar
Air consumption:	180 - 600 l/min
Weight, Ecco 40 / 40 S:	640 g
Weight, Ecco 401:	1 020 g

Selection of gun (paint nozzle size) without suction cup

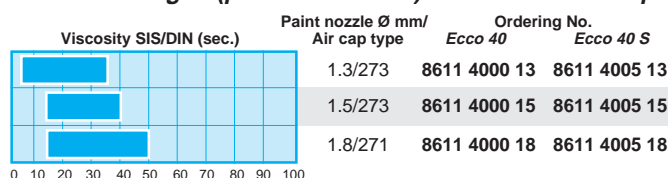

Selection of gun (paint nozzle size) with suction cup

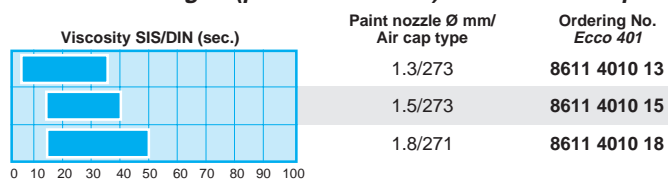

See also chart at page 14.

Ecco 402 / 402 S – Gravity feed



Spray gun with 0.5 lit. swivelling cup with drip guard.

Technical data	
Paint nozzles:	0.8 - 6.5 mm
Paint connection:	G 3/8
Air connection:	G 1/4
Air pressure:	max. 7 bar
Air consumption:	200 - 500 l/min
Weight:	800 g

Selection of gun (paint nozzle size)

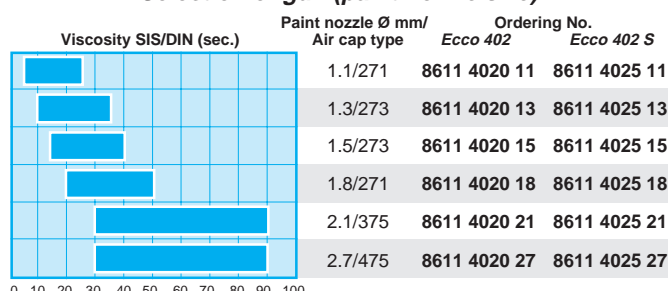

See also chart at page 14.

Ecco Automatic Spray Guns – for industrial applications

For continuous industrial painting

Ecco Automatic Spray Guns have been developed to meet the broad demands of today's paint processes. They are durable and give significant advantages in performance, and are easy to service.

For every paint job

High capacity and perfect spray pattern ensures excellent finish even at high production levels.

For every material

A wide range of air caps and paint nozzles that will suit your application is one of Ecco's distinguishing features.

For mounting on robotic arms

Ecco 60 A features a simple rigid mounting for precise and quick installation. Prepared for remote fan width control.

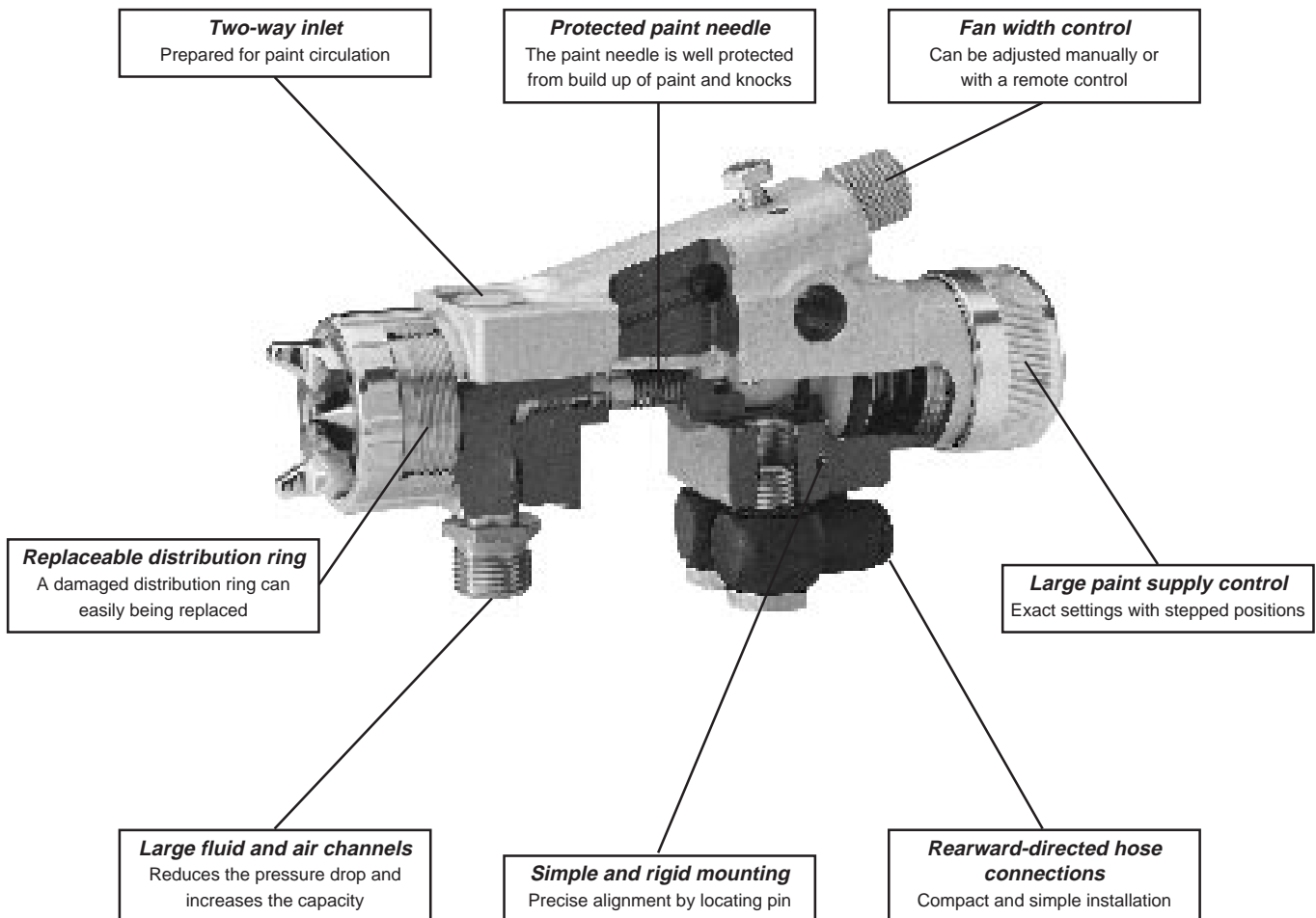

Correct nozzle combination for efficient spraying

Regardless of the type of fluid to be sprayed Ecco offers a wide variety of nozzle combinations.

For further information refer to our spare parts list or your local Ecco distributor.

Ecco Automatic Spray Guns – reliable and efficient

Ecco 60 A / AS – Automatic



The Ecco 60 A and 60 AS are compact and well adapted to its purpose. The paint needle is opened with compressed air and closed by spring action. The short reaction time ensures a perfect spraying result and low paint consumption. The needle seal is adjustable during operation. Ecco 60 AS is a stainless steel version for abrasive and corrosive fluids. The guns are service friendly, only standard tools required.

Technical data	
Paint nozzles:	0.8 - 2.7 mm
Paint connection:	G 3/8
Air connection:	Ø 8 mm quick coupling for nylon hose
Air pressure:	max. 7 bar
Control air pressure:	min. 4 bar
Air consumption:	250 - 700 l/min
Weight:	800 g

Accessories	Ord. No.
Kit for remote control	6003 6691 80

Selection of gun (paint nozzle size)

Viscosity SIS/DIN (sec.)	Paint nozzle Ø mm/ Air cap type	Ordering No.	
		Ecco 60 A	Ecco 60 AS
10 - 20	1.1/T278	8611 6160 49	8611 6160 62
20 - 30	1.3/T272	8611 6160 15	8611 6160 63
30 - 40	1.5/T272	8611 6160 18	8611 6160 67
40 - 50	1.8/T272	8611 6160 23	8611 6160 68
50 - 60	2.1/T374	8611 6160 33	8611 6160 69
60 - 70	2.7/T474	8611 6160 35	8611 6160 70

For further combinations, see spare parts list.

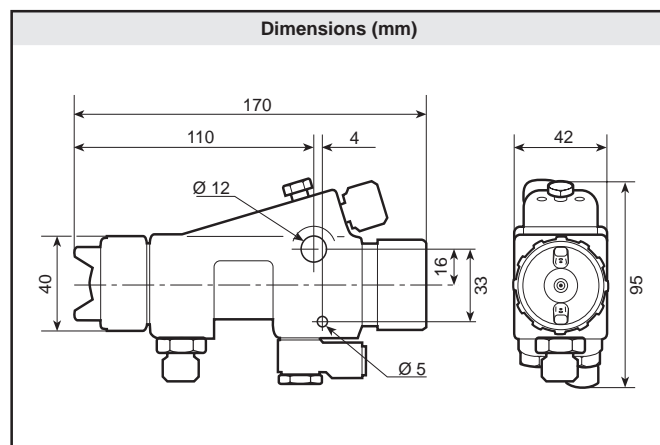

Ecco 40 DA – Automatic Diaphragm type



The Ecco 40 DA is an automatic spray gun for spraying abrasive and other similar compounds. The gun has no paint needle. The material flow is accurately controlled by a diaphragm, sealing against a tungsten carbide seat. The gun is small and easy to install.

Technical data	
Paint nozzle:	1.3 - 2.1 mm
Paint connection:	G 3/8
Air connection:	G 1/4
Air pressure:	max. 6 bar
Air consumption:	250 - 700 l/min
Weight:	350 g

Selection of gun (paint nozzle size)

Flow rate, approx. l/min.	Viscosity (SIS/DIN) sec.	Paint nozzle Ø mm/ Air cap type	Ordering No.
1.3	25 - 100	1.3/T272	8611 5210 25
1.5	25 - 100	1.5/T272	8622 5210 10
2.0	25 - 100	1.8/T274	8611 5210 66
2.5	25 - 100	2.1/T374	8611 5210 67

For further combinations, see spare parts list.

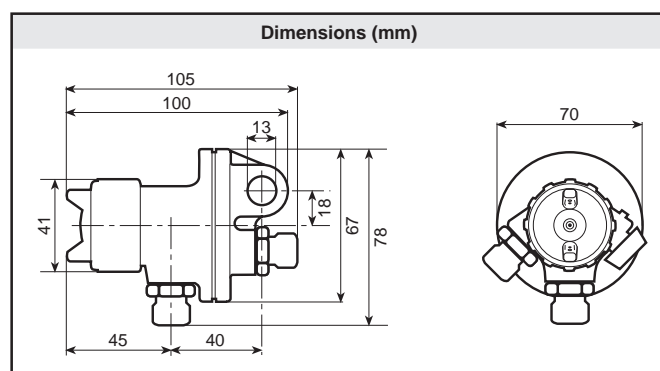

Ecco Spray Pack – ready-to-use spraying units

The Ecco Spray Pack equipment is based on the ready-to-use principle. A Spray Pack unit consists of all the equipment necessary to start to spray.

Although we have chosen the most commonly used guns and pumps, you can select the equipment to create your own Spray Pack.

Gravity feed

Ideal equipment when spraying small amounts of paint and frequent colour changes. Suitable for viscosity between 10 - 35 sec.



Type	Ord. No.
Spray Pack 111	8613 2311 10
• Spray gun Ecco 402 incl. paint nozzle Ø 1.3 mm	8611 6030 62
• Air filter/regulator LR 510 R	8202 0212 52
• Air hose, Ø 8 mm (5/16"), L= 8 m incl. coupl.	6003 7363 08

Suction feed

Perfect equipment when spraying small amounts of paint and frequent colour changes. Suitable for viscosity between 15 - 50 sec.



Type	Ord. No.
Spray Pack 112	8613 2311 28
• Spray gun Ecco 401 incl. paint nozzle Ø 1.8 mm	8611 6010 90
• Air filter/regulator LR 510 R	8202 0212 52
• Air hose, Ø 8 mm (5/16"), L= 8 m incl. coupl.	6003 7363 08

Pressure feed, cup 2.5 l

Suitable for continuous spraying and touch-up jobs. The capacity is approx. twice as much compared with suction fed guns. Suitable for viscosity between 10 - 35 sec.



Type	Ord. No.
Spray Pack 113	8613 2311 36
• Spray gun Ecco 40 incl. paint nozzle Ø 1.3 mm	8611 6013 06
• Pressure cup PRC 2, 2.5 l	8622 0100 00
• Air hose, Ø 6.3 mm (1/4"), L= 1.5 m incl. coupl.	6003 7360 97
• Paint hose, Ø 6.3 mm (1/4"), L= 1.5 m incl. coupl.	6003 7366 97

Pressure feed from 9 l tank

Suitable for continuous spraying and touch-up jobs. The capacity is approx. twice as much compared with suction fed guns. Suitable for viscosity between 10 - 35 sec.



Type	Ord. No.
Spray Pack 109	8613 2311 09
• Spray gun Ecco 40 incl. paint nozzle Ø 1.3 mm	8611 6013 63
• Pressure feed tank P9R 3.2, 9.0 l	8622 0116 09
• Air hose, Ø 8 mm (5/16"), L= 8 m incl. coupl.	6003 7363 08
• Paint hose, Ø 6.3 mm (1/4"), L= 8 m incl. coupl.	6003 7366 08

Ecco Feed Spray Pack

In the Ecco Feed Spray Packs the paint is circulated using air powered piston or diaphragm pumps. Compact and light equipment, ready-to-use and easy to clean.

An Ecco Feed Spray Pack consists of:

- Paint feeding pump with silencer and strainer
- Paint pressure regulator with gauge for precise

settings of the paint pressure. The regulator also works as a pulsation damper

- Reduction valve with gauge for precise settings of the air pressure
- An Ecco 40 spray gun including a paint nozzle that can handle the most common fluids
- All the necessary valves, hoses and couplings
- Earthing device

Feeding from a diaphragm pump

For all types of paint, but particular suitable when spraying abrasive fluids. The paint feeding unit is mounted either on a lid for a 20 l paint container or on a bracket for wall mounting.



Type	Ord. No.
Spray Pack 105 (for container)	8613 2311 31
• Paint feeding unit Ecco Feed AT 15 L	8613 2311 30
• Spray gun Ecco 40 incl. paint nozzle Ø 1.3 mm	8611 6013 06
• Air hose, Ø 8 mm (5/16"), L= 8 m incl. coupl.	6003 7363 08
• Paint hose, Ø 6.3 mm (1/4"), L= 8 m incl. coupl.	6003 7366 08
<i>Accessories:</i>	
• Stirrer ELM 40 F	8610 0112 05
Spray Pack 106 (for wall mounting)	8613 2311 41
<i>Same as Spray Pack 105, but with:</i>	
• Paint feeding unit Ecco Feed AT 15 B	8613 2311 40
<i>Accessories:</i>	
• Stirrer ELM 33 F-G 1	8610 0110 61

Technical data – Ecco Feed AT 15

The main component is a double-action diaphragm pump equipped with an inlet strainer. Suitable for pumping abrasive materials. The low utilization of the pump capacity contributes to a long service life. Wetted pump parts are made of teflon and acetal plastic.

Air outlet connection to gun:	G 1/4 male
Paint connection:	G 3/8 male
Air connection:	Quick coupling for 10 mm hose
Paint pressure:	max. 4 bar
Air pressure:	max. 6.8 bar
Pressure ratio:	1:1
Paint flow rate:	approx. 1.5 l/min
Air consumption:	approx. 10 l/min
Net weight:	9 kg

Feeding from piston pump

For all types of paint. Handy paint unit for quick paint changes. Mounted on a lid for 20 l paint container or on a tubular steel frame for use with different paint containers.



Type	Ord. No.
Spray Pack 117 (for container)	8613 2311 77
• Paint feeding unit Ecco Feed A 2	8621 0210 08
• Spray gun Ecco 40 incl. paint nozzle Ø 1.3 mm	8611 6013 06
• Air hose, Ø 8 mm (5/16"), L= 8 m incl. coupl.	6003 7363 08
• Paint hose, Ø 6.3 mm (1/4"), L= 8 m incl. coupl.	6003 7366 08
<i>Accessories:</i>	
• Stirrer ELM 33 F	8610 0110 63
Spray Pack 117 H (steel frame)	8613 2311 85
<i>Same as Spray Pack 117, but with:</i>	
• Paint feeding unit Ecco Feed A 2 H	8621 0210 32
<i>Accessories:</i>	
• Stirrer ELM 33 F-G 1	8610 0110 61

Technical data – Ecco Feed A 2

The main component is a single-action pump equipped with an inlet strainer. Design features that contribute towards a long service life include teflon piston rod gasket, chrome-plated stainless steel piston rod, nitrided stainless steel cylinder and a glass-fibre-reinforced teflon piston gasket.

Air outlet connection to gun:	G 1/4 male
Paint connection:	G 3/8 male
Air connection:	Quick coupling for 10 mm hose
Paint pressure:	max. 3 bar
Air pressure:	max. 7.5 bar
Pressure ratio:	1:2
Paint flow rate:	approx. 1 l/min
Air consumption:	approx. 10 l/min
Net weight:	9 kg

Accessories

Nozzle set

Consists of air cap, paint nozzle of stainless steel and paint needle of nylon.
For all manual Ecco 40 guns.

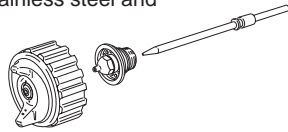

Paint nozzle Ø mm	Pressure feed (Air cap, type)	Suction and Gravity feed (Air cap, type)
1,1	6003 9772 11 (T278)	6003 9771 11 (271)
1,3	6003 9772 13 (T272)	6003 9771 13 (273)
1,5	6003 9772 15 (T272)	6003 9771 15 (273)
1,8	6003 9772 18 (T272)	6003 9771 18 (271)
2,1	6003 9772 21 (T374)	6003 9771 21 (375)
2,7	6003 9772 27 (T474)	6003 9771 27 (475)

For ordering separate nozzles, see page 15.

Throttle valve

To be mounted on the air inlet of the gun.
Connection threads:
G 1/4 female - G 1/4 male

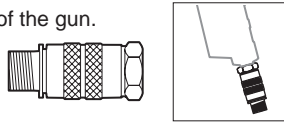

For gun	Ord. No.
Ecco 40 / 401 / 402 / -S	6003 8002 00

Service kit

Contains gaskets, seals and other wear components.
Detailed installation instructions included.

For gun	Ord. No.
Ecco 40 / 401 / 402	6103 0762 00
Ecco 40 S / 402 S	6003 9095 00
Ecco 60 A / 60 AS	6003 6572 00

Strainer insert

Strainer made of nylon. Fits behind the paint nozzle.
For all manual Ecco 40 guns.

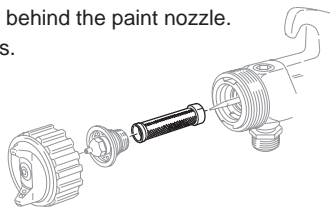

Mesh size		Colour	Qty per set	Ord. No.
mesh	mm			
60	0.25	White	10	6103 3200 00
100	0.15	Yellow	10	6103 3201 00
200	0.07	Black	10	6103 3202 00
300	0.05	Red	1	6103 1088 00

Connecting pipe

To be mounted between the gun and the paint hose.
Improves the balance and reduces the weight in the hand.

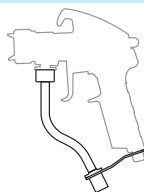

For gun	Ord. No.
Ecco 40 / 40 S	6001 3161 00

Paint cup



Type	Volume, l	Weight, g	Ord. No.
Pressure cup for Ecco 40 / 40 S / 30 P18			
PRC 2	2.5	1 500	8622 0100 00

Suction cups for Ecco 40 S / 401 / 30 S18 / 301 S18			
SD 10 aluminium	1.0	530	6803 4867 00
Extra cup SD 10 (without lid)	1.0		6803 4968 00
SD 10 T aluminium/teflon	1.0	530	6803 4869 00
Extra cup SD 10 T (without lid)	1.0		6803 4969 00
SDT 15 aluminium/teflon	1.0	550	6003 9676 00
Extra cup SDT 15 (without lid)	1.0		6003 9677 00

Gravity cup for Ecco 402 / 402 S			
Plastic cup	0.5	150	6101 5575 00

Strainer set for paint cups

Fits on the suction pipe with outside diam. 9 – 12 mm.

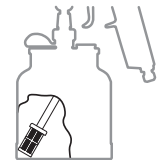

For cup	Size, mesh	Qty per set	Ord. No.
PRC 2, SD 10/T, SDT 15	80	10	6003 7886 00

Paint circulation set

Complete set of circulation pipe and couplings.



For gun	Ord. No.
Ecco 40 (manual)	6103 3387 80
Ecco 60 AS (automatic)	6003 9670 00

Cleaning brush

For cleaning nozzles and paint channels.



Diameter, mm	Ord. No.
10	6000 8004 00
17	6000 8001 00

Viscosity cup

Cup made of plastic or aluminium for measuring the viscosity.



Type	Ord. No.
Plastic	6803 3567 00
Aluminium	6003 7582 00

Accessories

Air filter/Pressure regulator



Dry and clean air at a constant pressure is an important factor to achieve a good result when spraying.

LR 510 R is an efficient combined air filter, water trap and pressure regulator. Compact design and easy maintenance ensures high reliability. It is easy to install.

It is equipped with reduction valve and gauge. Two guns can be connected at the same time. The air filter will collect particles larger than 15 µ.

Technical data	
Inlet connection thread:	G 1/2 female
Outlet connection thread:	G 1/4 male
Max. working pressure - primary:	14 bar
- secondary:	8 bar
Capacity at a primary circuit pressure at 6 bar:	1 500 l/min

Type	Ord. No.
LR 510 R	8202 0212 52

Air hose/Coupling



Despite its strength it is flexible enough to accompany the gun movements. Per metre or in standard 8 m lengths incl. couplings G 1/4 female with cap nut.

Inside diam.	Ord. No.	Ord. No.	Ord. No.
mm inch	per metre	coupling G 1/4	compl. 8 m
6,3 1/4	6003 6686 00	6001 1235 00	6003 7360 08
*8,0 5/16	6003 7346 00	6003 7338 00	6003 7363 08
9,5 3/8	6803 6687 00	6001 1239 00	6203 1460 08

* Recommended.

Paint hose/Coupling



Eccoflex is resistant to paints, solvents, weak acids or water at temperatures of up to +100°C. Outer sheathing of reinforced polyester and the inner hose of nylon. Per metre or L= 8 m, incl. coupl. G 3/8 female with cap nut.

Inside diam.	Ord. No.	Ord. No.	Ord. No.
mm inch	per metre	coupling G 3/8	compl. 8 m
*6,3 1/4	6803 6684 00	6003 5629 00	6003 7366 08
9,5 3/8	6803 6685 00	6001 1241 00	6003 7369 08

* Recommended.

Nylon hose/Coupling

Resistant and flexible hoses for air or paint. Inside diameter 6 mm.

Type	Ord. No.
Nylon hose, per metre	6003 6884 00
Coupling G 1/4 with cap nut	6003 7341 00
Coupling G 3/8 with cap nut	6003 7342 00

Quick coupling

Quick couplings for air with hole diam. 7 mm.

Connection type	Ord. No.
6.3 mm (1/4") - Coupling QIC 10A H06	8202 1302 02
8 mm (5/16") - Coupling QIC 10A H08	8202 1302 10
10 mm (3/8") - Coupling QIC 10A H10	8202 1302 28
G 1/4 - Coupling QIC 10A M8	8202 1302 36
G 3/8 - Coupling QIC 10A M10	8202 1302 44
6.3 mm (1/4") - Nipple NIP 10A H06	8202 1202 11
8 mm (5/16") - Nipple NIP 10A H08	8202 1202 94
10 mm (3/8") - Nipple NIP 10A H10	8202 1202 29
G 1/4 - Nipple NIP 10A M08	8202 1202 45
G 1/4 - Nipple NIP 10A F08	8202 1202 86

Jointing nipple

Jointing nipples with cone for hose coupling at one end.



Thread male	Hole Ø mm	Material	Ord. No.
G 1/4 - G 1/4	7	Nickle-plated brass	6001 2619 00
G 1/4 - 9/16 20G	7	Nickle-plated brass	6000 1877 00
G 1/4 - G 3/8	7	Nickle-plated brass	6001 2617 00
G 3/8 - G 3/8	7	Nickle-plated brass	6001 3156 00
G 3/8 - G 3/8	9.5	Zinc-plated steel	6803 1250 00

Hose clamp

Delivered in set of 5 pcs.

For hose with outer diam. mm	Ord. No.
7.0 - 8.5	0347 0122 05
8.5 - 10.0	0347 0122 06
9.8 - 11.8	0347 0122 07
11.3 - 13.3	0347 0122 08
12.8 - 14.8	0347 0122 09
14.6 - 16.8	0347 0122 10
16.5 - 18.8	0347 0122 11

Hose nipple

Hose nipple G 1/4 male. For air and paint hose. Not for nylon.

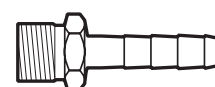

For hose with inner diam.		Ord. No.
mm	inch	
6.3	1/4	6000 3347 00
8.0	5/16	6003 7345 00
9.5	3/8	6000 4116 00

Paint and air valve



Connection thread	Hole diam. mm	Max. working pressure, bar	Ord. No.
G 1/4 male	6	16	6803 0300 00
G 3/8 male	9	16	6803 0301 00
G 1/4 female	7	40	6003 7774 00
G 3/8 female	7	40	6003 7775 00

Ecco Pressure Feed Tanks

Closed and safe paint handling

The Ecco Pressure Feed Tanks are suitable for all sprayable material and provide safe storage. Having almost no wearing parts they are first choice for paints with abrasive pigments.

To prevent the build up a static charge all of the tanks have an earthing device.

Complete, ready for start up

The tanks are made of galvanized steel and as standard equipped with regulator, pressure gauge, safety relief valve, re-filling port and ball valves for air and paint.

You just have to fill up paint and connect to air supply and spray gun.

Volume 9 – 90 litres. Other sizes or stainless steel versions available on request.

Pneumatic stirrer

For continuous stirring Ecco Pressure Feed Tanks with a manual stirrer can easily be equipped with an explosion proof air motor.

Top or bottom feed

For more viscous materials Ecco tanks with bottom outlet should be used.

Approved and safe

Ecco Pressure Feed Tanks conforms regarding material, design and safety standards with requirements set by the Swedish and German authorities The GS-marking of the tanks stand for tested for safety by the German Safety Control Board TÜV.

Ecco Pressure Feed Tank

Air connection: G 1/4 male. Paint connection: G 3/8 male.



Top feed

Type	Volume litre	Air pressure max., bar	Height mm	Inner diam. mm	Width mm	Weight kg	Ord. No.
P9R-3.2	9	3.2	520	210	330	6	8622 0116 09
P12R-6	12	6	545	245	350	25	8622 0116 12
P12RA-6*	12	6	695	245	350	27	8622 0116 13
P24R-6*	24	6	945	245	350	32	8622 0116 24
P45R-4*	45	4	885	360	470	46	8622 0116 45
P45R-6*	45	6	885	360	470	46	8622 0116 46
P90R-6*	90	6	1165	360/440	470	63	8622 0116 90

* With manual stirrer

Bottom feed

Type	Volume litre	Air pressure max., bar	Height mm	Inner diam. mm	Width mm	Weight kg	Ord. No.
P24RP-6	24	6	795	245	525	30	8622 0116 25
P45RP-4	45	4	735	360	645	44	8622 0116 47
P45RP-6	45	6	735	360	645	44	8622 0116 48

Air motor for stirrer

Explosion proof air powered motor for Ecco tanks with stirrers. Including bracket, quick coupling for air hose, speed control valve and silencer.

Air consumption at 100 – 150 rpm: 150 – 200 l/min.



Type	Ord. No.
ELM 33 P	8610 0110 60

Overflow protector

Facilitates the filling of Ecco Pressure Feed Tanks 12 – 500 litres.



Type	Ord. No.
StopFlow	6003 9157 60

Earthing device

To prevent the build up of a static charge when feeding inflammable fluids. Delivered complete with 6 m cable.



Type	Ord. No.
Earthing device	6203 0532 00

Personal protection

Fresh air hood Junior

Junior is recommended for spray painting. The hood will protect the wearer against dust and fumes. The large window which can be raised is covered by protective foil.

The Fresh air hood Junior includes innerhood, protecting foil (10 pcs.), air hose and belt with throttle valve with nipple for connection to air hose Ø 6.3 mm (1/4") female.

Air consumption: 150 – 200 l/min.



Type	Ord. No.
Fresh air hood Junior	8615 0133 35
Accessories	Ord. No.
Innerhood, set of 5 pcs.	6803 6678 00
Protecting foil, set of 100 pcs.	6803 6679 00

Air filter

Air filter for breathing air. Can be connected directly to the air supply. The filter will remove particles larger than 0.01 µ, oil fumes and odours. The filter **will not** remove methane, carbon monoxide or other toxic gases.



Technical data	
Working pressure:	max. 6 bar
Normal working pressure to safety helmet:	3 bar
Air capacity:	420 l/min
Air connections:	G 1/4 female
Weight:	2.5 kg

Type	Ord. No.
Air filter AFR 13	8202 0216 26
Accessories	Ord. No.
Bracket for wall-mounting	6003 6764 00
Prefilter	9090 1762 00
Ceramic filter	1202 6257 01
Chemical filter	1202 6281 01

Breathing mask Max

A breathing mask should always be worn when working in the presence of strong solvents and paints. The rubber breathing mask covers the nose and mouth and is designed for use with goggles. The mask will protect the wearer against dust and organic gases.

A standard mask includes filter holder, prefilter and chemical filter.



Type	Ord. No.
Breathing mask Max	6803 3072 00
Accessories	Ord. No.
Prefilter	6802 9844 00
Chemical filter	6802 9845 00

Air thermostat Vortex

For air conditioning of fresh air helmets and hoods. The temperature of the breathing air (warm/cold) is adjustable.

An air thermostat Vortex includes hose nipple Ø 1/4" female. To be installed between air filter and helmet.



Type	Ord. No.
Air thermostat Vortex	8615 0133 36

Hose for breathing air

Air hose made of wear resistant PVC. Approved by Swedish Authorities. Delivered per metre. Outer diam. 11 mm.

Type	Ord. No.
Air hose, innerdiam. 1/4"	6003 9598 00
Coupling G 1/4 with cap nut and hose clamp	6001 1235 00
Quick coupling QIC 10A H06	8202 1302 02
Nipple NIP 10A H06	8202 1202 11
Hose clamp	0347 0122 07

Ecco 30

Light weight – Easy to use – Top finishing result

Ecco 30 is the perfect solution for all types of paint jobs where a top finishing result is more important than output capacity. Thanks to its design and low weight it is very easy to use.

Easy to use

Ecco 30 can be used for solvent as well as water based paints. The suction and gravity fed guns come as standard with relevant paint cups. Fan width, paint and air flow output controls are simple to use and can easily be adjusted even when the gun is in operation.

Precision built

The gun body is manufactured from cast aluminium, the paint nozzle and paint needle from stainless steel. The air cap is nickel-plated brass and is designed to give excellent atomization. The packings are teflon-made, which makes the gun lubrication free. Thanks to its design the gun is very easy to clean.

The multipurpose spray gun

The Ecco 303 features a 0.25 l gravity cup and 1.0 mm paint nozzle which makes it ideal for ornamental work.

Ecco 30 P13



Pressure feed spray gun.
Viscosity SIS/DIN: approx. 15 - 35 sec.

Technical data	
Paint nozzle diam.:	1.3 mm
Paint connection:	G 3/8
Air connection:	G 1/4
Air pressure:	max. 7 bar
Air consumption:	290 l/min
Weight:	410 g

Type **Ord. No.**
Ecco 30 P13 **8611 3000 30**

Ecco 302 G18



Gravity feed spray gun with 0.4 l gravity cup.
Viscosity SIS/DIN: approx. 15 - 35 sec.

Technical data	
Paint nozzle diam.:	1.8 mm
Paint connection:	cup 0.4 l
Air connection:	G 1/4
Air pressure:	max. 7 bar
Air consumption:	170 l/min
Weight:	610 g

Type **Ord. No.**
Ecco 302 G18 **8611 3000 20**

Ecco 30 S18



Suction feed spray gun without cup.
Viscosity SIS/DIN: approx. 15 - 35 sec.

Technical data	
Paint nozzle diam.:	1.8 mm
Paint connection:	G 3/8
Air connection:	G 1/4
Air pressure:	max. 7 bar
Air consumption:	170 l/min
Weight:	410 g

Type **Ord. No.**
Ecco 30 S18 **8611 3000 10**

Ecco 303 G10



Gravity feed spray gun with 0.25 l gravity cup. Ideal for ornamental works.
Viscosity SIS/DIN: approx. 8 - 15 sec.

Technical data	
Paint nozzle diam.:	1.0 mm
Paint connection:	cup 0.25 l
Air connection:	G 1/4
Air pressure:	max. 7 bar
Air consumption:	100 l/min
Weight:	520 g

Type **Ord. No.**
Ecco 303 G10 **8611 3000 25**

Ecco 301 S18



Suction feed spray gun with 1.0 l suction cup SDT 15.
Viscosity SIS/DIN: approx. 15 - 35 sec.

Technical data	
Paint nozzle diam.:	1.8 mm
Paint connection:	G 3/8
Air connection:	G 1/4
Air pressure:	max. 7 bar
Air consumption:	170 l/min
Weight incl. cup:	760 g

Type **Ord. No.**
Ecco 301 S18 **8611 3000 15**

Service kit

Contains packings, seals and other wearing parts. For all Ecco 30 spray guns.

Type **Ord. No.**
Service kit **6003 9631 00**

Accessories

Type **Ord. No.**
Gravity cup G05, for Ecco 302 G18 **6803 4970 00**
Gravity cup G02, for Ecco 303 G10 **6003 9525 00**

Ref. other accessories, please see page 8 - 9.

Basic Spraying Technique

To obtain the best possible finishing result it is important that the correct spraying technique is used. Nozzle combination and the paint used are factors that will affect the result.

The size and shape of the work piece to be sprayed will of course have an influence on the finishing result.

A correct balance between air and paint pressure is essential to the result.

The setting of the air and paint pressure depending on:

- **The viscosity and nature of the material being sprayed**
- **The spraying technique and the production capacity**
- **The nozzle combination used**
- **The gun distance and the fan width**

Paint pressure

The paint pressure should be set as low as possible with respect to the required paint output. If the paint pressure is set too high it could lead to a lack of air to atomize the paint.

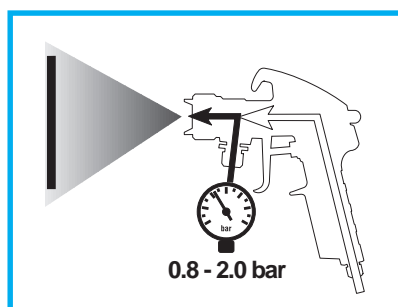

Air pressure

The air pressure should also be set as low as possible with respect to the finishing result required. The air that reaches the work piece bounces back in different directions. Too high setting of the air will result in lower transfer efficiency and incorrect spray pattern, therefore adjust the air pressure to the type of paint and paint output of the gun. Remember that clean and dry air are essential for your finishing result.

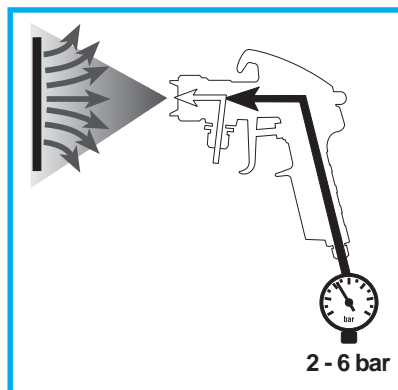

Fan width

All paint that does not reach the work piece will effect the environment and your paint economy.

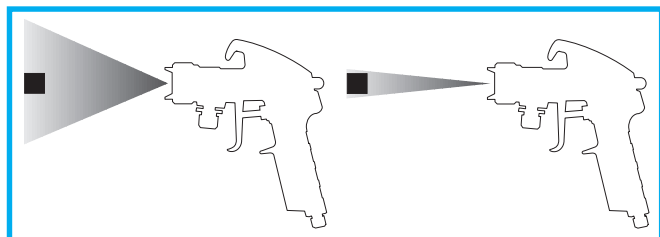

A fraction of the paint ends up on the work piece

With a significant lower paint output, the same amount ends up on the work piece

Distance to the work piece

Regardless of the equipment chosen the distance to the work piece should be maintained as short as possible. This is a factor that will greatly influence your transfer efficiency.

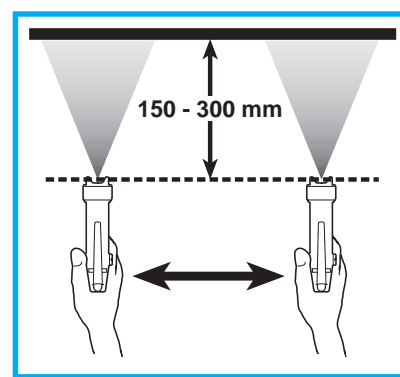

Strokes

Always point the gun at right angles to the surface you are painting. Spray in horizontal even and calm strokes. Edges, corners and hard to reach areas should be sprayed first. Finish with the larger visible areas by spraying from edge to edge without interrupting in the middle. 50% overlapping should be maintained.

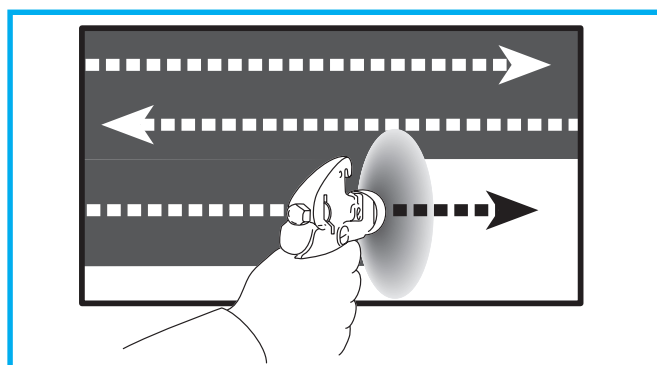

Cleaning the spray gun

At shorter stops in using the gun, for instance during the night, it is enough if the air cap and the paint nozzles are cleaned with soft brush soaked in solvent. At longer stops or storage always flush the gun through with solvent. Do not immerse the gun in solvent since it will dissolve the lubrication oil inside the gun.

The correct choice for your application

Pressure feed guns

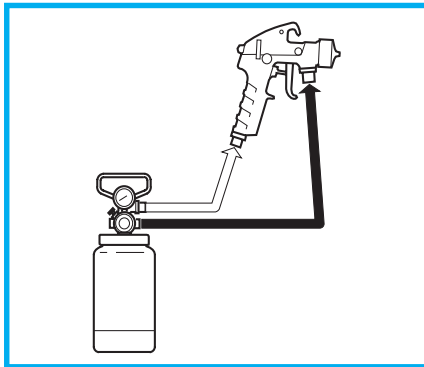

On pressure feed guns the paint is forced through the gun by either a pressure pot, pump unit or a circulation system.

This setup is suitable for continuous spraying and touch-up jobs.

Suction feed guns

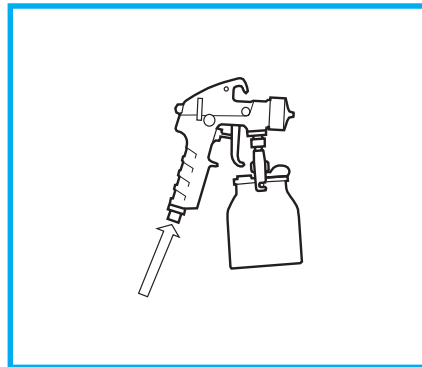

A stream of air through the gun creates a vacuum at the air cap and the paint is siphoned from the suction cup.

This setup is recommended for smaller paint jobs where frequent colour changes are required.

Gravity feed guns

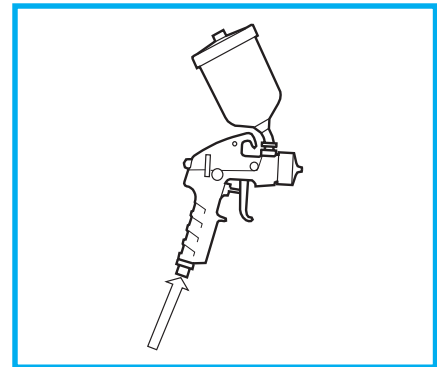

The paint is drawn to the paint nozzle by gravity, as well as the siphon effect of the air cap.

The capacity is slightly higher than suction feed guns and also the capability of handling more viscous materials.

Guidelines for selection of the right spray gun

Below you will find a chart for the most suitable gun for arrange of different application. The chart should be considered as a guideline only.

Nozzle combinations

On the next page all available paint nozzles, needles and air caps are grouped with regards to the size of the paint nozzle and type of gun.

Method	Type of gun/ Paint nozzle diam., mm/ Type of air cap <small>*Paint nozzle and needle made of tungsten carbide</small>	Body Shop			Wood				Work Shop				Ceramic		Other				Ordering No.	
		All types	Metallic Top coat	High Solids	Base coat Top coat	Stain	Polyester	Glue (Latex or solvent based)	Primer	Rust proofing	Fillers Putty	Epoxy	Enamel	Enamel/Laquer	Domestic appliances					
PRESSURE	40/1.1/T274					☞														8611 6013 60
	40/1.1/T278	☞	☞	☞													☞			8611 4040 11
	40/1.3/T272				☞				☞											8611 4040 13
	40/1.3/T274											☞								8611 6013 63
	40/1.5/T274										☞									8611 6013 62
	40/1.8/T272*													☞						8611 6023 59
	40/2.1/T374*												☞	☞						8611 6023 61
	40 S/1.8/T272							☞							☞					8611 4045 18
	40 S/1.8/T274								☞											8611 6120 63
SUCTION	401/1.2/170					☞														8611 4010 12
	401/1.5/273		☞																	8611 4010 15
	401/1.8/271	☞			☞				☞	☞						☞				8611 4010 18
	401/1.8/275			☞								☞								8611 4010 38
	401 S/2.1/375							☞												8611 4015 21
GRAVITY	402/1.2/170					☞														8611 4020 12
	402/1.3/273		☞																	8611 4020 13
	402/1.5/275			☞																8611 4020 35
	402/1.8/271	☞			☞				☞											8611 4020 18
	402/1.8/271*									☞					☞					8611 4029 18
	402/1.8/275											☞								8611 4020 38
	402/1.8/275*												☞							8611 4029 38
	402/2.1/375							☞		☞	☞									8611 4020 21
	402 S/2.1/375								☞											8611 4025 21

Nozzles combinations for Ecco 40

Paint nozzle diameter mm	Paint nozzles						Paint needles						Air caps								
	Stainless steel		Tungsten carbide		Nylon		Nylon		Stainless steel		Tungsten carbide		Suction feed Gravity feed		Air consumpt. l/min at 4 bar	Pressure feed		Round spray with stop ring 6101 3298	Air consumpt. l/min at 4 bar		
Type	Ord. No.	Type	Ord. No.	Type	Ord. No.	Type	Ord. No.	Type	Ord. No.	Type	Ord. No.	Type	Ord. No.	Type		Ord. No.	Type			Ord. No.	
0.8	0-7	6001 0241						P007	6101 5747	007	6001 0548			170	6101 2588	215			M070	6101 3291	65
	B0-7	6001 0966						P007	6101 5747	007	6001 0548			270	6101 2589	285	T272	6101 2599	480		
														271	6101 5249	380	T278	6101 5614	470		
1.1																	T272	6101 2599	480		
	09-7	6001 1068						P007	6101 5747	007	6001 0548						T272*	6102 3992	480		
1.2																	T278	6101 5614	470		
	1-7	6001 0276			P1-7	6001 1476	P07	6001 1471	07	6000 9275	H07	6000 9881	170	6101 2588	215		T278*	6102 3991	470	M170	6101 3292
1.3																	T272	6101 2599	480		
	1.5-7	6001 0999	H1.5-7	6001 1092	P1.5-7	6001 1477	P07	6001 1471	07	6000 9275	H07	6000 9881	271	6101 5249	380	T272*	6102 3992	480			
							P1307*	6101 5982					273	6103 3159	370	T274	6101 2602	490			
1.5																	PT274**	6101 5785	490		
																	T278	6101 5614	470		
	1.5	6103 1303					P07	6001 1471	07	6000 9275	H07	6000 9881	270	6101 2589	285	T278*	6102 3991	470			
1.8																					
	2-7	6000 9140	H2-7	6001 0768	P2-7	6001 1478	P07	6001 1471	07	6000 9275	H07	6000 9881	271	6101 5249	380	T274	6101 2602	490	M270	6101 3293	155
2.1																	PT274**	6101 5785	490		
	3-7	6000 9141	H3-7	6000 9876	P3-7	6001 1479	P07	6001 1471	07	6000 9275	H07	6000 9881	273	6103 3159	370						
2.7																					
	4-7	6000 9142	H4-7	6000 9877			P07	6001 1471	07	6000 9275	H07	6000 9881	375	6101 2591	385	T374	6101 2603	510	M370	6101 3294	265
3.7																					
	5-7	6000 9287					P57	6101 6056	57	6000 9289							T474	6101 2604	510	M470	6101 3295
6.5																					
	6-7	6001 0451															T576	6101 2607	540	M570	6101 3296
																	T676	6101 2608	585		

* Paint needle with cylindrical point (self-cleaning tip)

* With acetal plastic retaining ring ** Nylon design